

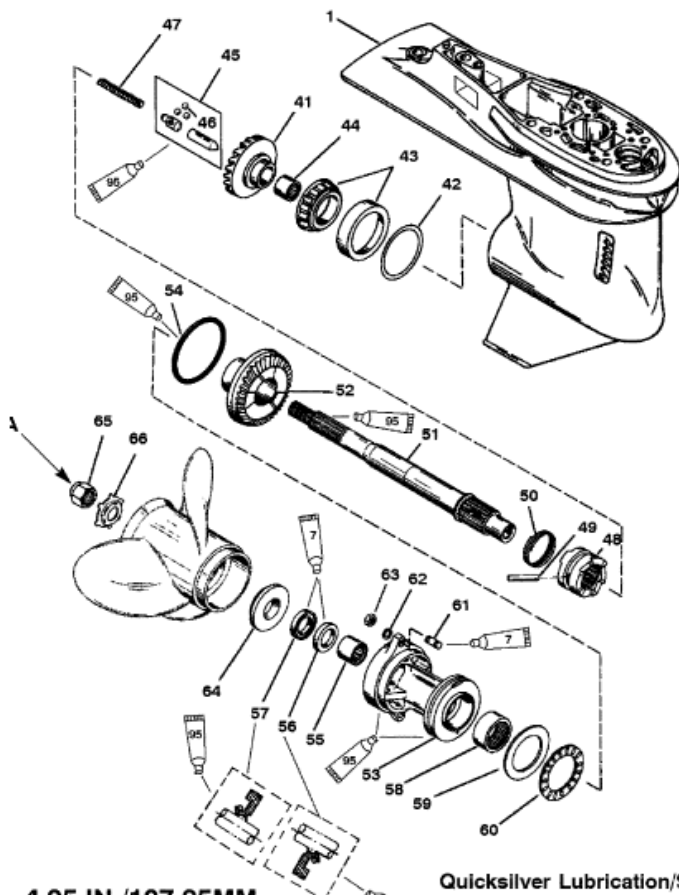

(SEE NOTE ON Q/H CHART BEFORE ORDERING FROM THIS PAGE)



**4.25 IN./107.95MM
 TORPEDO DIA.
 2.31:1 GEAR RATIO**

A - TORQUE NUT TO 55 LB. FT. (74.6 N-M).

Quicksilver Lubrication/Sealant Application Points

-  2-4-C With Teflon (92-825407A12)
-  Loctite 271 (Obtain Locally)

Parts List

Ref	Class	Part	Description	Qty	Comment	Footnote
1	1667	9011G 8	GEAR HOUSING	1	(BLACK)	
1	1667	9011G 9	GEAR HOUSING	1	(GRAY)	
41	43	850033A 2	FORWARD GEAR (30 TEETH)	1		3
42	15	44491A 1	SHIM ASSEMBLY	1		
43	31	30894A 1	TAPERED ROLLER BEARING	1		
44	31	30895	ROLLER BEARING	1		
45		850315A 1	CAM FOLLOWER ASSEMBLY	1		3
46	30	44530	BALL	3		
47	24	850327	SPRING	1		3
48	52	850048	CLUTCH	1		3
49	17	30632	CROSS PIN	1		
50	24	30893	SPRING	1		
51	44	850308	PROPELLER SHAFT	1		3
52	43	850034	REVERSE GEAR (30 TEETH)	1		3
53		12596A 2	BEARING CARRIER ASSEMBLY	1		
54	25	97386	O-RING	1		4,9
55	31	30956	ROLLER BEARING	1		
56	26	70080	OIL SEAL (INNER)	1		9
57	26	70081	OIL SEAL (OUTER)	1		9
58	31	12578	ROLLER BEARING	1		
59	12	12577	THRUST WASHER	1		
60	31	12576	THRUST BEARING	1		
61	16	42917 2	STUD (M8 X 48)	2		1
62	12	855941	WASHER	2		
63	11	40119 8	NUT	2		
64		13191A 1	THRUST HUB ASSEMBLY	1	THESE PARTS ARE NOT INCLU	
65	11	52707A 1	PROPELLER NUT ASSEMBLY	1	THESE PARTS ARE NOT INCLU	
66	14	816629	TAB WASHER GEAR HOUSING	1	THESE PARTS ARE NOT INCLU	
-	26	43035A 4	G/H SEAL KIT	1		
-	27	43004A90	GASKET SET	1		